

DRWG No
10-2935

THIRD ANGLE PROJECTION. DIMNS. IN MM

316 ST. STEEL INTERFACE

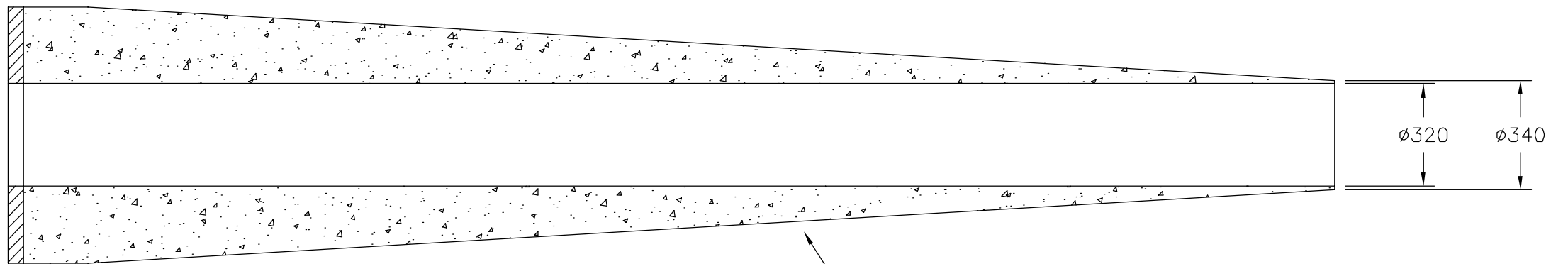
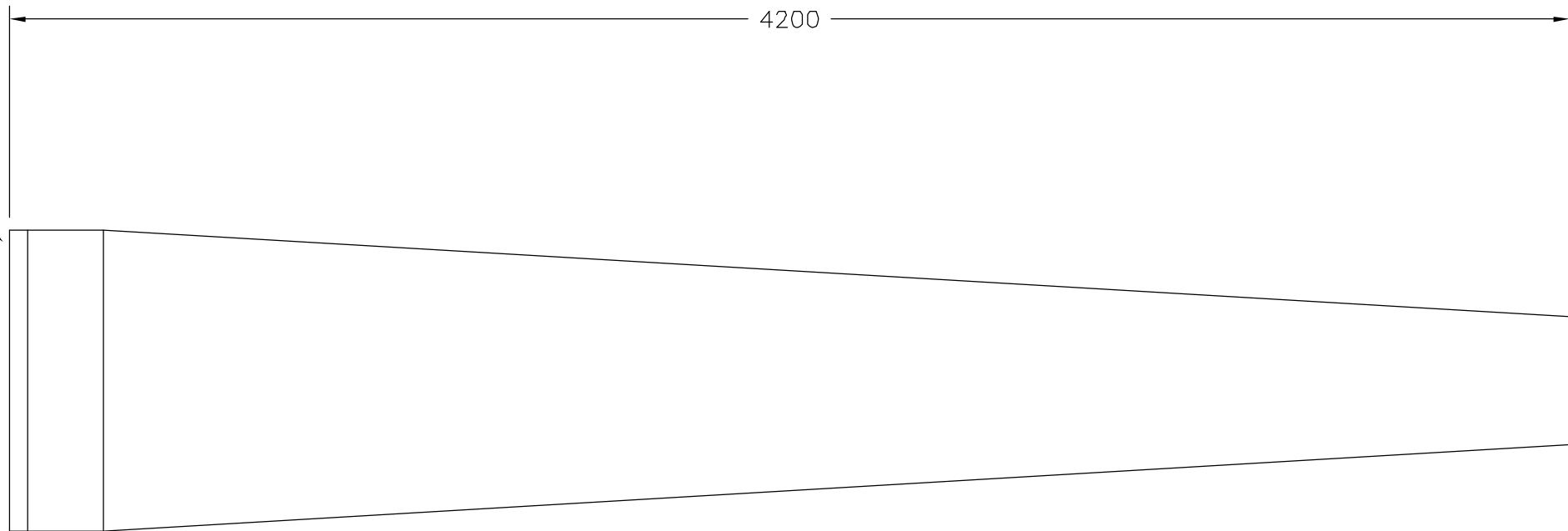
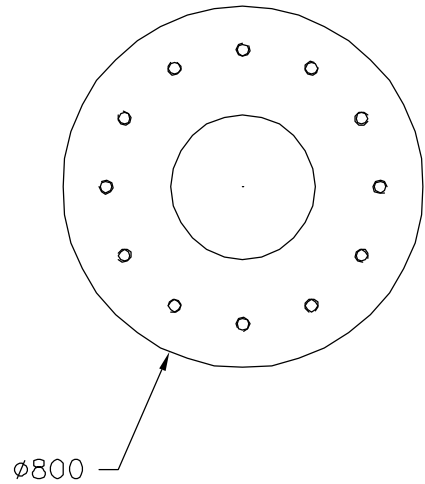

CAST POLYURETHANE

PERFORMANCE 95kN AT 65° AT R3900

WEIGHT IN AIR 1350kg
WEIGHT IN WATER 250kg

DATE 15Mar'00				CWA DESIGN COPYRIGHT NOT TO BE USED OR RE- PRODUCED WITHOUT EXPRESS PERMISSION FROM CWA	TOLERANCES :- UNLESS OTHERWISE STATED NO DEC PLACE ±0.5 ANGULAR ±1/4° 1 DEC PLACE ± 0.3 2 DEC PLACE ±0.15 HOLES UP TO 12.7mm +0.10mm -0 ALL COAXIAL DIAS CONCENTRIC WITHIN 0.05mm ALL HOLES ON PITCH CIRCLES WITHIN 0.10mm OF TRUE POS.	REMOVE ALL SHARP EDGES WITH 0.40 RAD OR CHAMFER UNLESS OTHERWISE STATED	MATERIAL	FINISH	SURFACE FINISH 0.8 UNLESS OTHERWISE STATED
DRAWN fjj							DRWG No. 10-2935		
SCALE NTS	15Mar'00		1				TITLE Ø315 PIPE BEND STIFFENER		
CHECKED	DATE	C.NOTE	ISS						

CWA PRODUCTS LIMITED HOOK BASINGSTOKE HANTS