

LOW DRAG AIRFOIL SECTION  
Cd 0.12

RIGID POLYURETHANE INSERTS

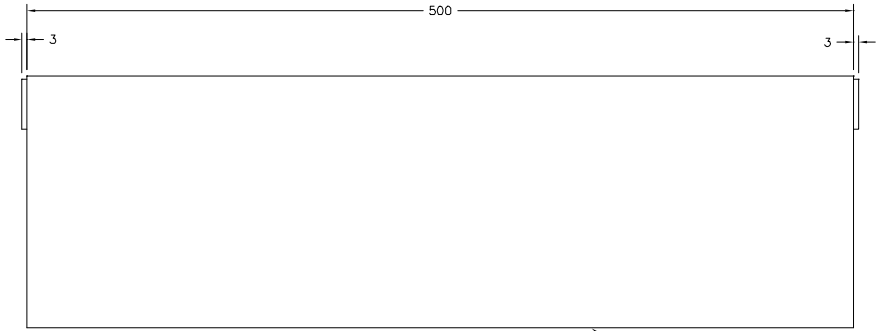

FLEXIBLE POLYURETHANE

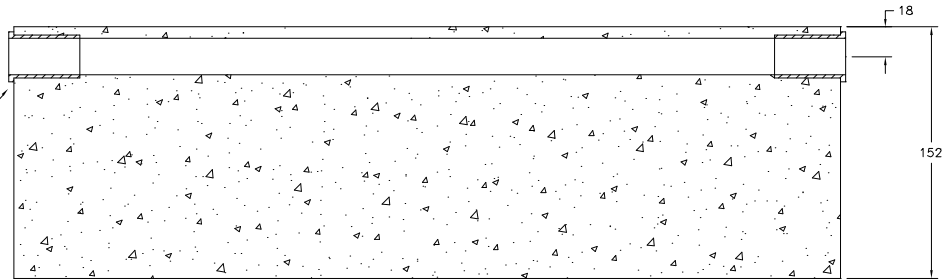

|         |          |          |     |
|---------|----------|----------|-----|
| DATE    | 9 Jul'99 |          |     |
| DRAWN   | fjj      |          |     |
| SCALE   | NTS      | 9 Jul'99 | 1   |
| CHECKED | DATE     | C.NOTE   | ISS |

CWA DESIGN COPYRIGHT  
NOT TO BE USED OR RE-  
PRODUCED WITHOUT EXPRESS  
PERMISSION FROM CWA

TOLERANCES :- UNLESS OTHERWISE STATED  
NO DEC PLACE  $\pm 0.5$  ANGULAR  $\pm 1/4^\circ$   
1 DEC PLACE  $\pm 0.3$  2 DEC PLACE  $\pm 0.15$   
HOLES UP TO 12.7mm  $+0.10\text{mm} -0$   
ALL COAXIAL DIAS CONCENTRIC WITHIN 0.05mm  
ALL HOLES ON PITCH CIRCLES WITHIN 0.10mm OF TRUE POS.

REMOVE ALL SHARP  
EDGES WITH 0.40 RAD  
OR CHAMFER UNLESS  
OTHERWISE STATED

MATERIAL

|                |                             |
|----------------|-----------------------------|
| SURFACE FINISH | <br>UNLESS OTHERWISE STATED |
| DRWG No.       |                             |

**CWA PRODUCTS LIMITED HOOK BASINGSTOKE HANTS**

TITLE MOULDED CABLE FAIRING FOR  $\phi 19$  ROPE